

# MLG-CCT Series

## Solid-Core Current Transformers - mA Output

### FEATURES

- Revenue Grade
- Standard Footprints
- 600V rated leads
- UL recognized

### APPLICATIONS

- Interfaces directly with the DTS range of AC Sub-meters
- Motor Load Measurement

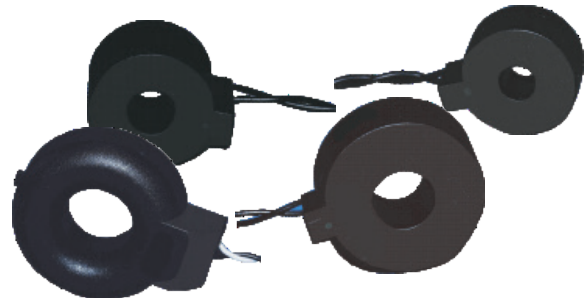

### DIMENSIONS\*

MLG-CCT	RATED CURRENT	DIMENSIONS (inches)					AWG	X <sup>+</sup>
P/N	(Amps)	A	B	C	D	E		
MLG-CCT-0280	40	0.92	1.16	0.44	0.28	3.94	28	C1
MLG-CCT-0350	50	1.02	1.25	0.67	0.35	3.94		C2
MLG-CCT-0510	75	1.45	1.70	0.55	0.51	3.50		C3
MLG-CCT-0750	200	1.89	2.36	0.67	0.75	7.88		C4

X<sup>+</sup> Use the CT size designator column as last digit of DTS model number when ordering MLG-CCTs with a DTS meter

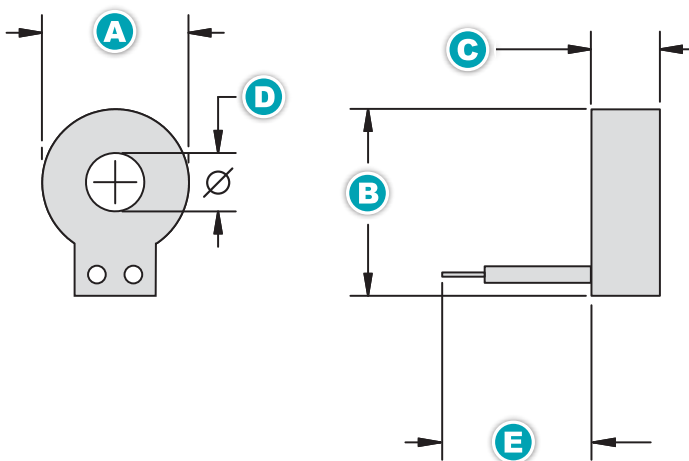

### SPECIFICATIONS

- Maximum Continuous Primary Current 4x I<sub>r</sub>
- Insulation Voltage 3500 Vac / 1min
- Storage Temp. -45°C thru +85 °C
- Operating Temp. -40°C thru +85 °C

MLG-CCT	I <sub>r</sub>	V <sub>max</sub> RMS	T <sub>e</sub> (typ.)	DCR Ω	Frequency
P/N	(Amps)				
MLG-CCT-0280	40	6.6	2510	134.0	20 - 1 KHz
MLG-CCT-0350	50	10.0	2490	187.0	20 - 1 KHz
MLG-CCT-0510	75	12.0	2512	160.0	20 - 1 KHz
MLG-CCT-0750	200	11.5	2011	74.0	20 - 1 KHz

I<sub>r</sub> = Maximum Input Current to be linearly sensed  
V<sub>max</sub> = Maximum Voltage (Saturation) CT will develop  
T<sub>e</sub> = Effective turns ratio including losses (All Specifications tested at 60 Hz)

Distributor:

Call Toll Free: 877-PQ-SOLNS (877-777-6567)

Fax (425) 799-4780

email: [info@measurlogic.com](mailto:info@measurlogic.com)

\* Drawings are for illustrative purposes only  
Technical details subject to change